



Double Arm Side of Pole/Wall Mount Bracket

(For use with Solarland SLP045-SLP075, and SLP080S-SLP100S Mono panels)

SLB-0113

The Solarland® SLB-0113 has been designed for use with the Solarland® SLP Series panels ranging in size from 45W-75W (U, C and C1D2 Series) and 80W-100W Special Series Mono panels. The double arm fixed bracket provides a safe and secure mount to a pole, wall or fence.

Specifications

Mounting Type	Double Arm Side of Pole/Wall Mount
Module Type	Specifically designed to work with Solarland SLP series panels, but can be adapted for use with other brands
Number of Modules	Mounts 1 Panel
Setting Angle	0°~90°
Wind Load	Designed to withstand wind speeds of 90mph
Snow Loading	1.1kN/m ²
Warranty	5 Years

Kit Components & Parts

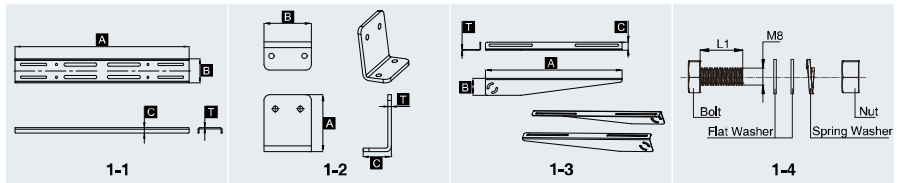
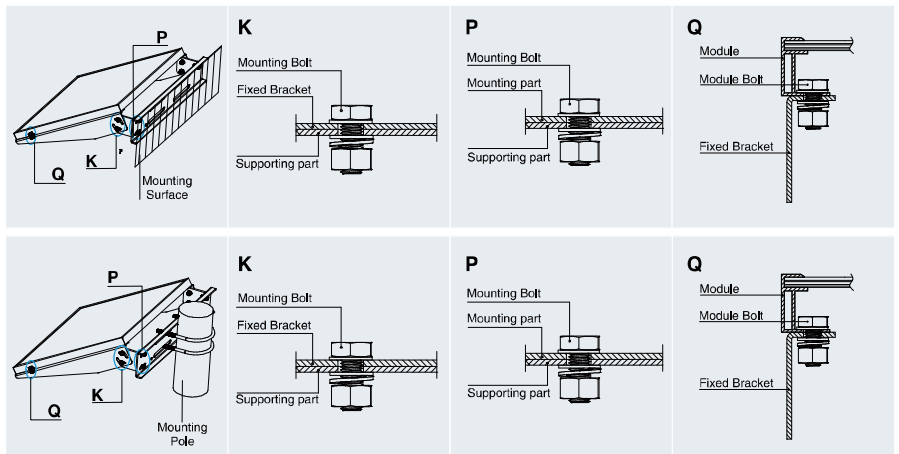

Diagram	Component	Material	Surface Treatment	Quantity	Dimensions
1-1	Fixed Bracket	5052Al	N/A	1	A=660mm[25.98in.], B=110mm[4.33in.] C=25mm[0.98in.], T=4.5mm[0.18in.]
1-2	Fixed Bracket	5052Al	N/A	2	A=100mm[3.94in.], B=83mm[3.27in.] C=50mm[1.97in.], T=6.5mm[0.26in.]
1-3	Tilt Arm	5052Al	N/A	2	A=540mm[21.26in.], B=82mm[3.23in.] C=40mm[1.57in.], T=3mm[0.12in.]
1-4	Module Bolt	AISI304	N/A	4	M8X25[0.98in.]
	Mounting Bolt	AISI304	N/A	8	M8X25[0.98in.]

*Note: U-Bolts or Steel Clamps are not supplied in this kit and must be procured separately if pole mount is required

Mounting Diagram



Note:

- When using this kit with another brand of panel you may need to change the module bolts (1-4) to suit the mounting holes on the panel. Kit includes M8 & M6 bolt sizes.

**Side of Pole/Wall
Mount Bracket**
(For use with Solarland
SLP045 – SLP075, and
SLP080S-SLP100S Mono panels)

SLB-0113

sales@solarlandusa.com
www.solarlandusa.com

